

R11020128x

Lv4-2020-r1

Modelo-model:

FIRRAK porto

Lote-Lot-Lot-Lot:



Peso-Weight-Poids-Gewicht:

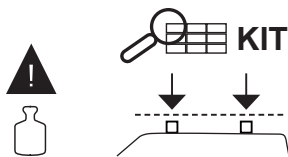

CEE - EEC type approval:



26 R- 04 3024

ES	Instrucción de montaje ¡Leer primero!	Portaequipajes
EN	Assembly instructions Read first!	Roof racks
FR	Instruction de montage Lire en premier!	Galleries
DE	Montageanleitung Zuerst lesen!	Dachgepäckträger

1





x1



x1

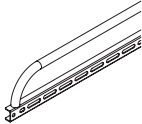
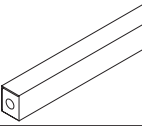
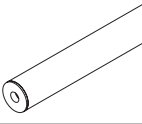
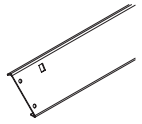

Código / Code	R110201284	R110201286	R110201288
	2x (738-110) 110 cm 2x (738-170) 170 cm	2x (738-110) 110 cm 2x (738-170) 170 cm	2x (738-110) 110 cm 2x (738-170) 170 cm
	8x (827-240) 140 cm	8x (827-251) 158 cm	8x (827-270) 170 cm
	2x (827-340) 140 cm	2x (827-353) 158 cm	2x (827-370) 170 cm
	1x (716-294) 140 cm	1x (716-295) 150 cm	1x (716-297) 170 cm
	1x (805-107) 1x (805-146) 1x (805-224) 1x (810-051)	1x (805-112) 1x (805-146) 1x (805-224) 1x (810-051)	1x (805-112) 1x (805-146) 1x (805-224) 1x (810-051)
Lote / Lot	01/20	01/20	01/20
Peso / Weight	25,32 Kg	27,50 Kg	28,13 Kg

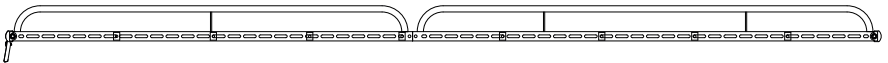

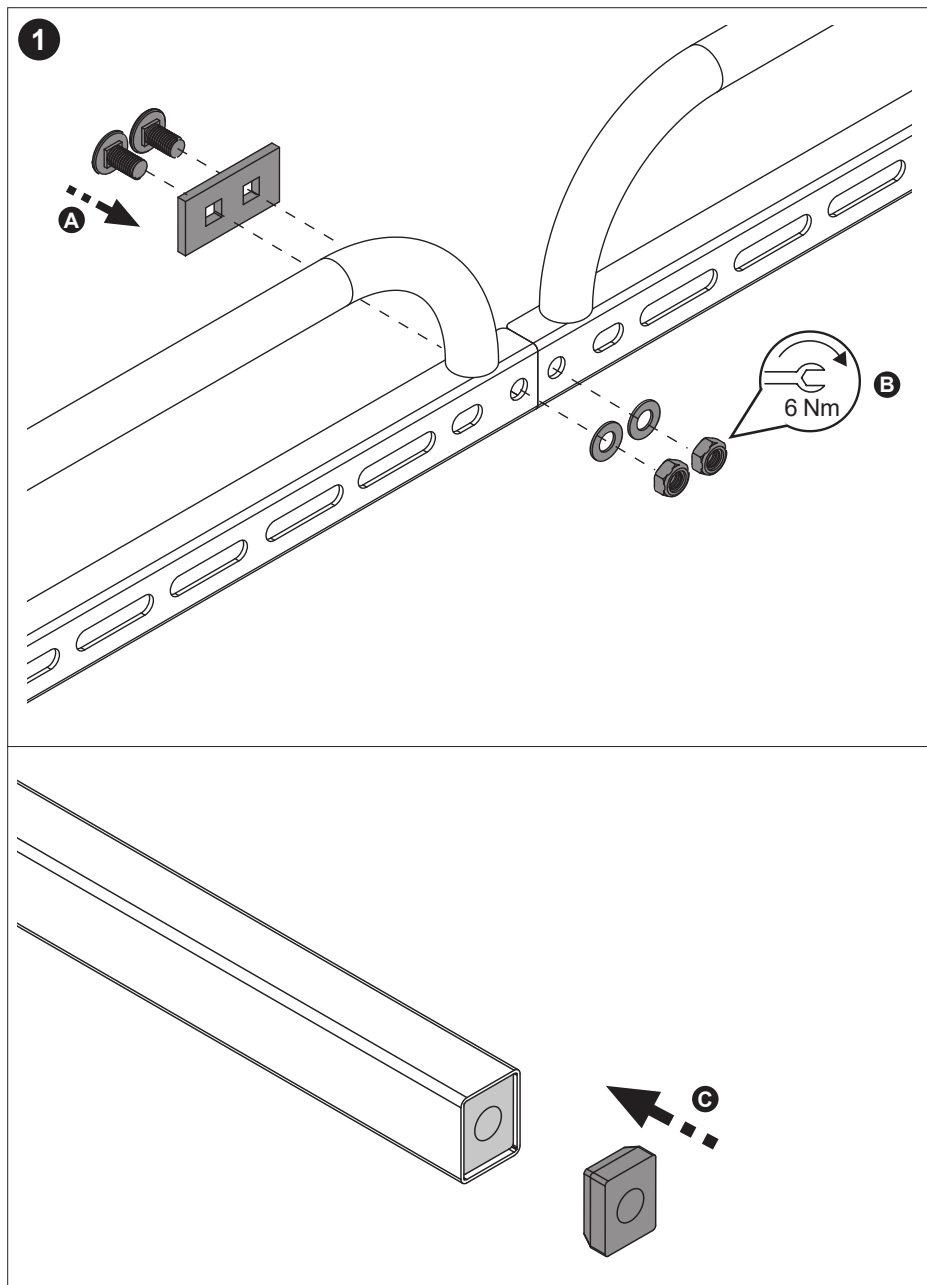

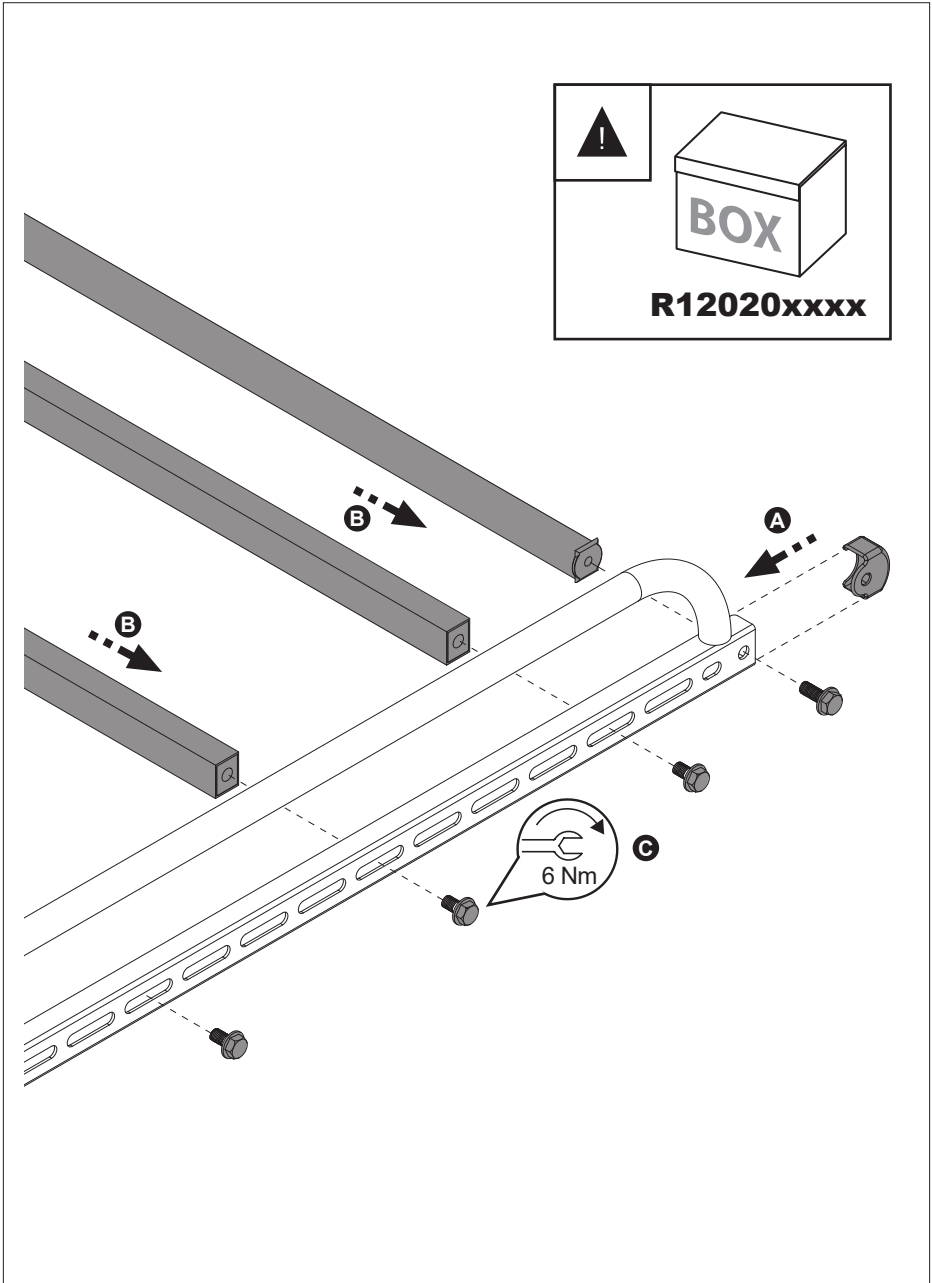

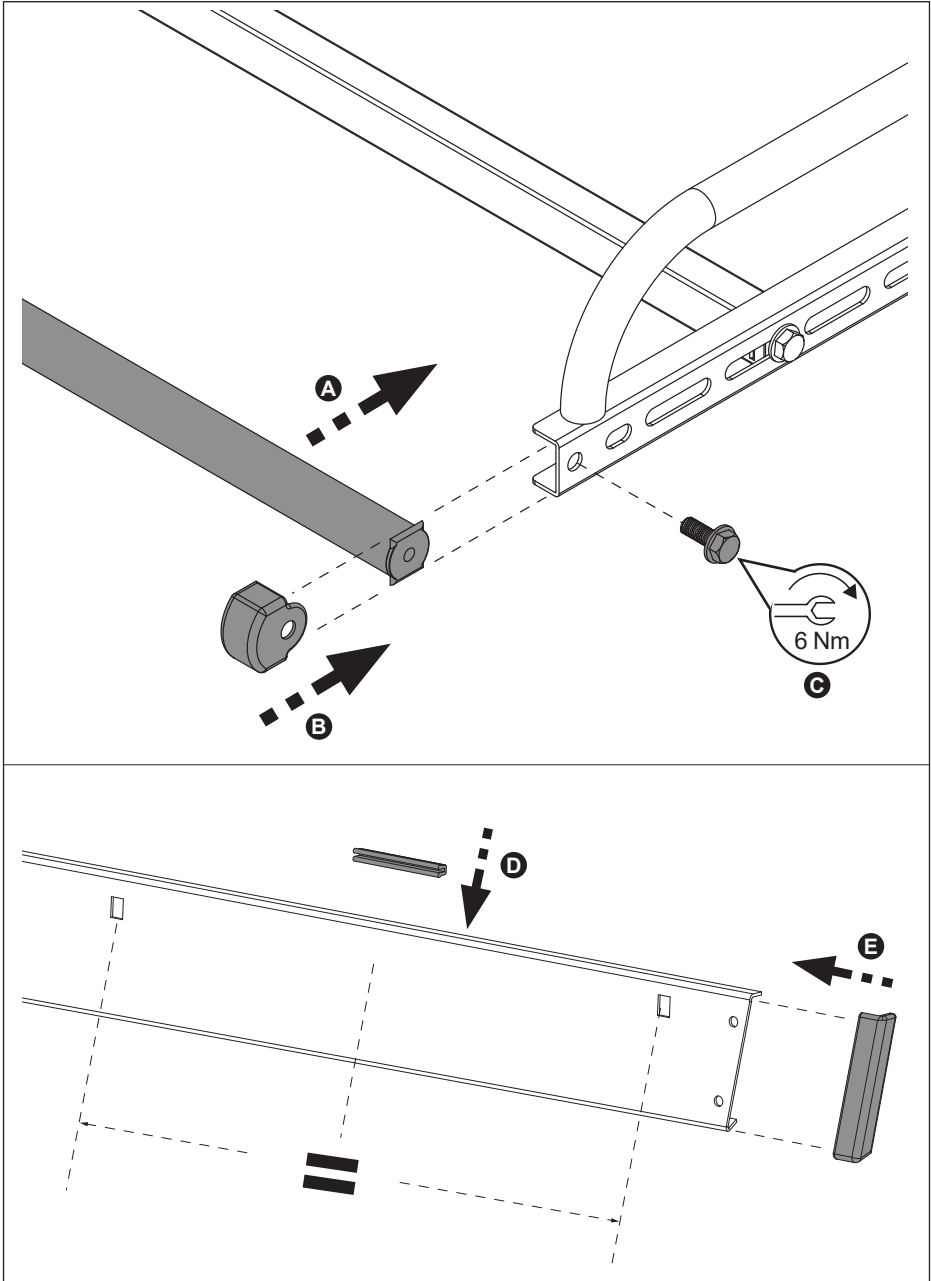

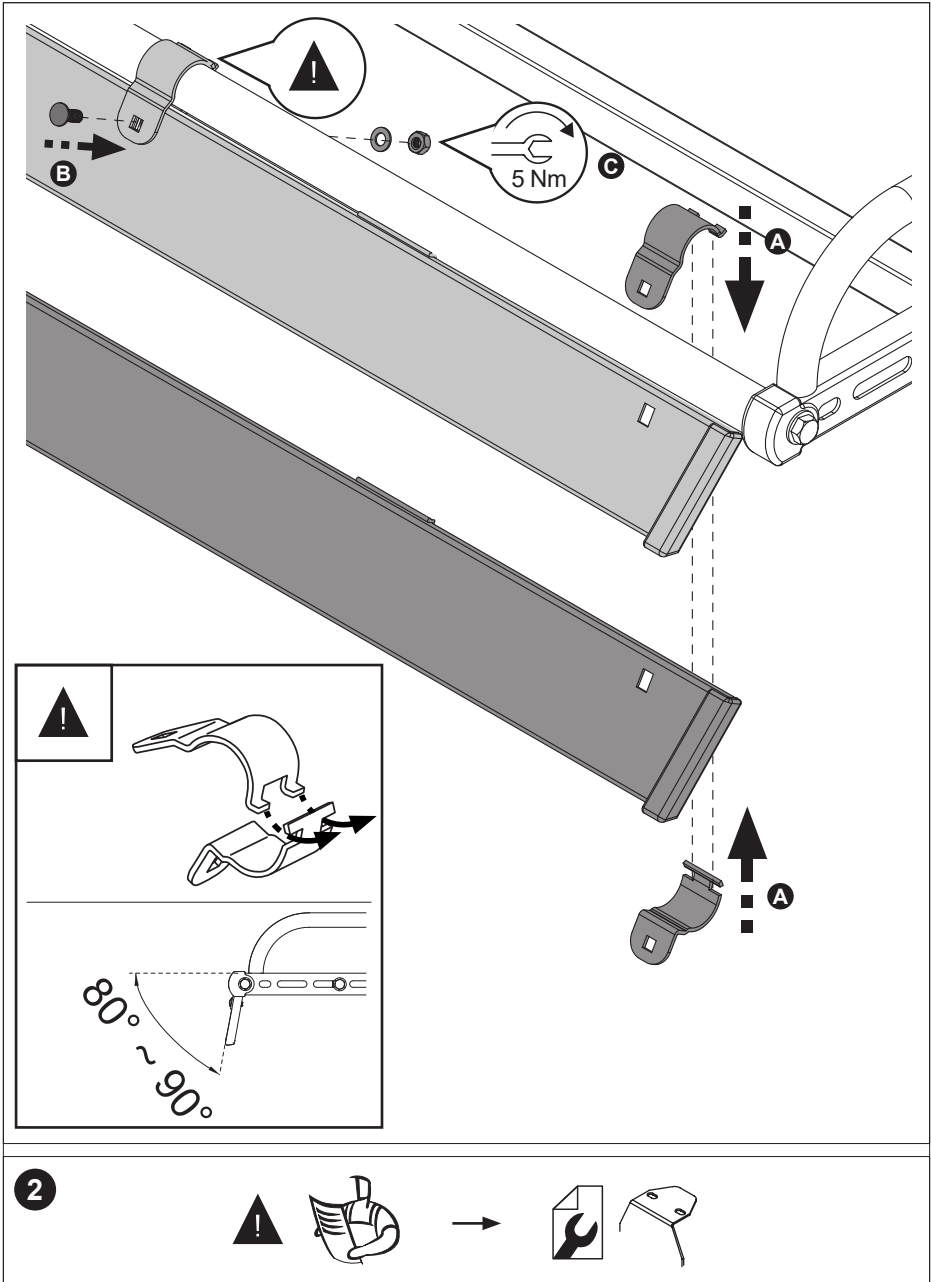



CRUZBER SA
ES-A14018311
Pol.Ind. Las Salinas II
14960 - Rute - Spain

www.firrak.com